

LEGEND	
	PROPOSED ROAD CONSTRUCTION
	PROPOSED FOOTPATH CONSTRUCTION
	PROPOSED RAISED TABLE
	PROPOSED SURFACE TO LANDSCAPE ARCHITECTS' DETAILS
	PROPOSED HOMEZONE
	PROPOSED PERMEABLE PAVING
	PROPOSED 125mm HIGH KERB
	PROPOSED 25mm HIGH KERB
	PROPOSED FLUSH KERB

- NOTES:
- DO NOT SCALE. USE FIGURED DIMENSIONS ONLY.
 - THIS DRAWING IS TO BE READ IN CONJUNCTION WITH ALL OTHER RELEVANT ARCHITECTURAL AND ENGINEERING DRAWINGS.

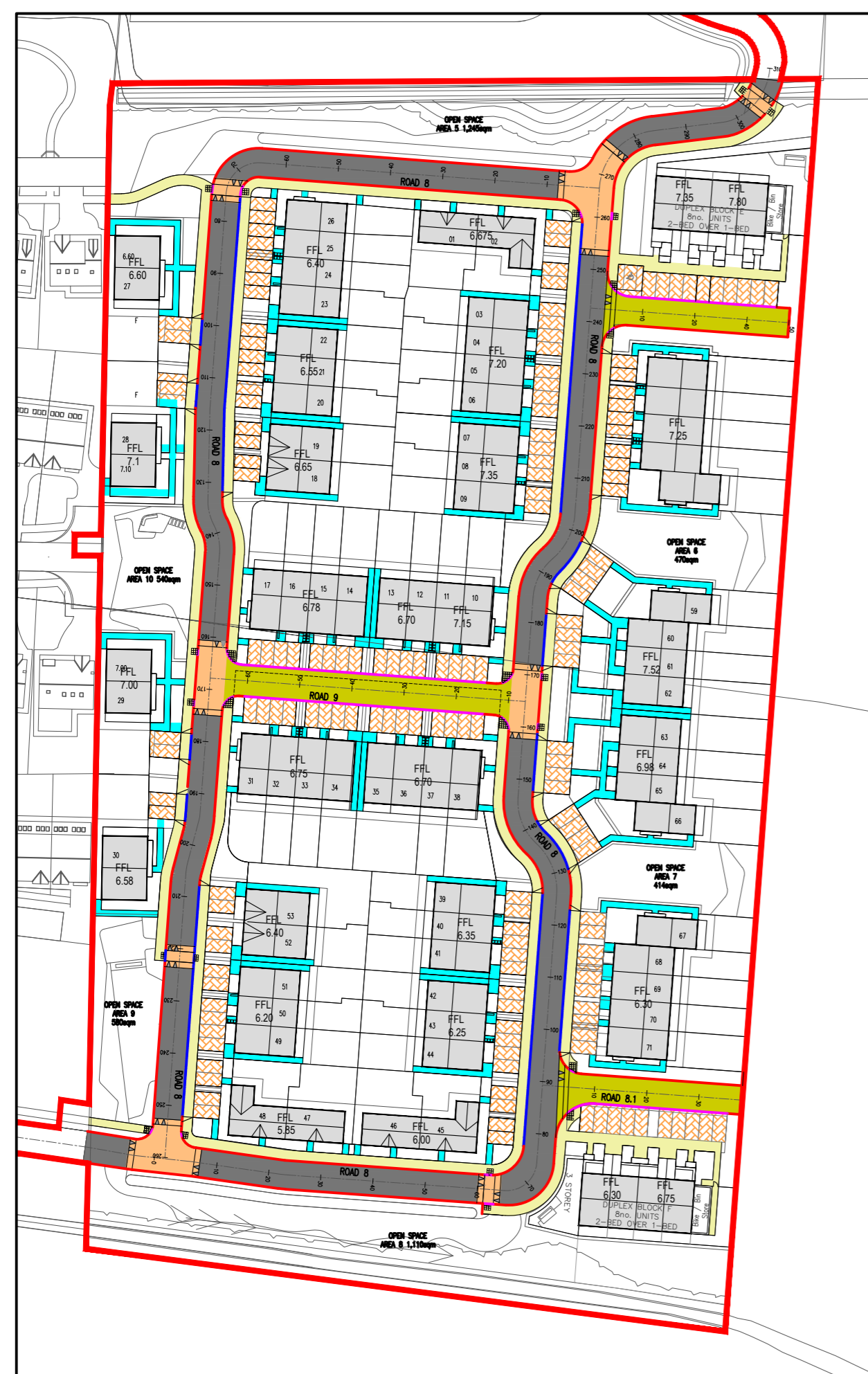

SOUTHERN SITE PLAN
SCALE 1:1000

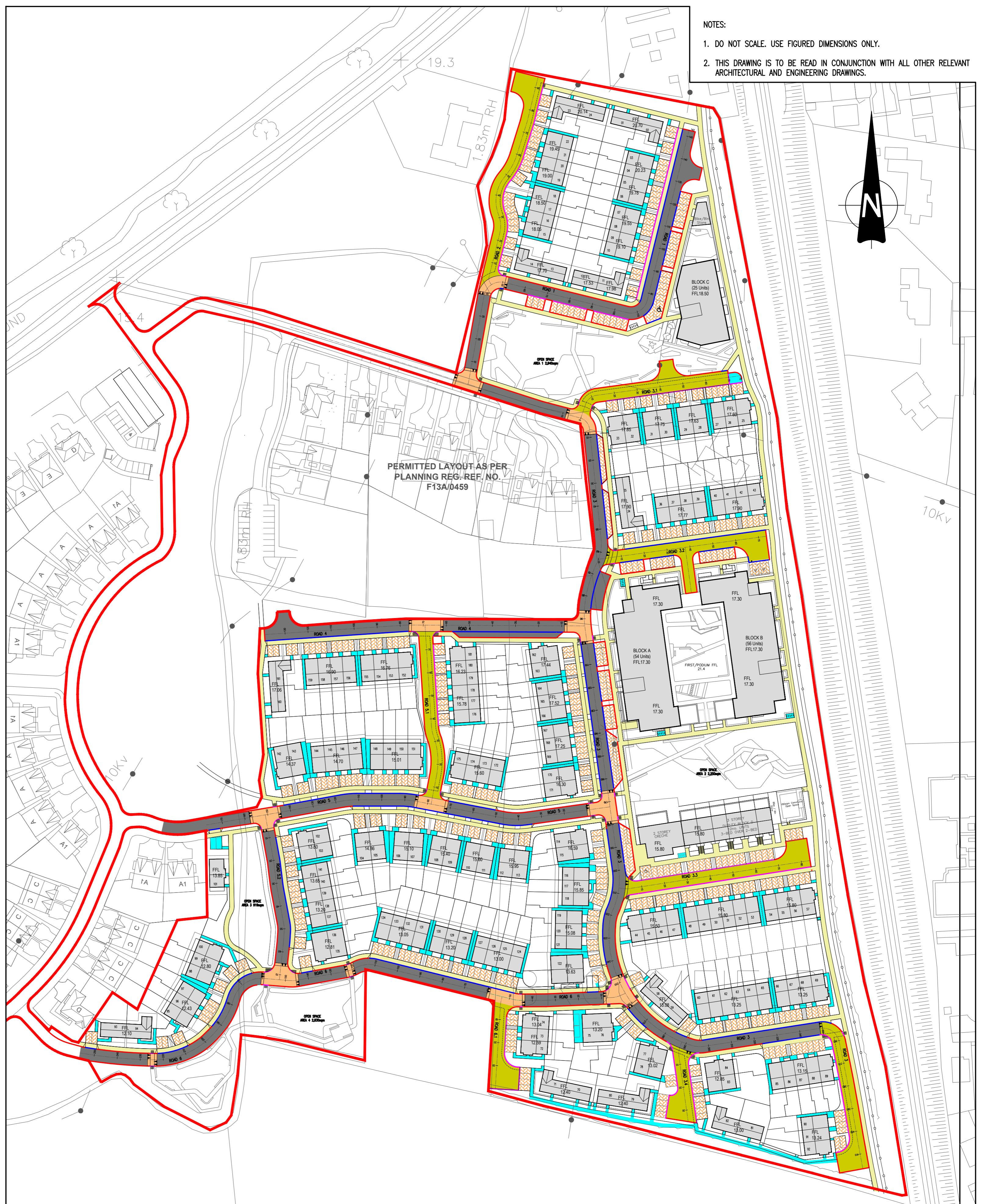
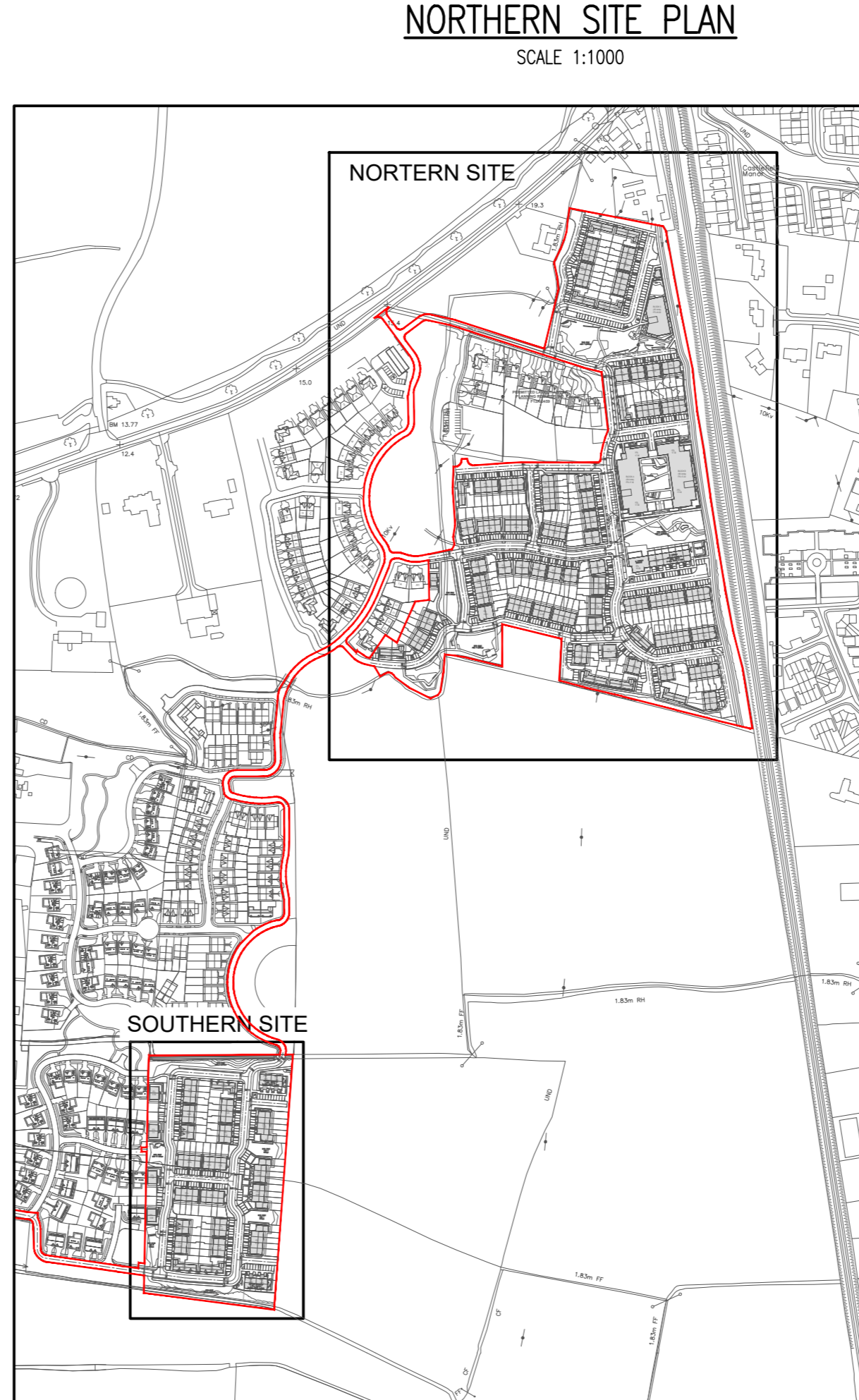

KEYPLAN PLAN
SCALE 1:5000

NORTHERN SITE PLAN

SCALE 1:1000

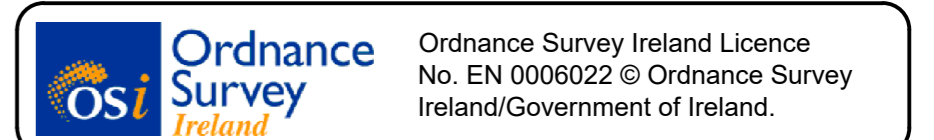
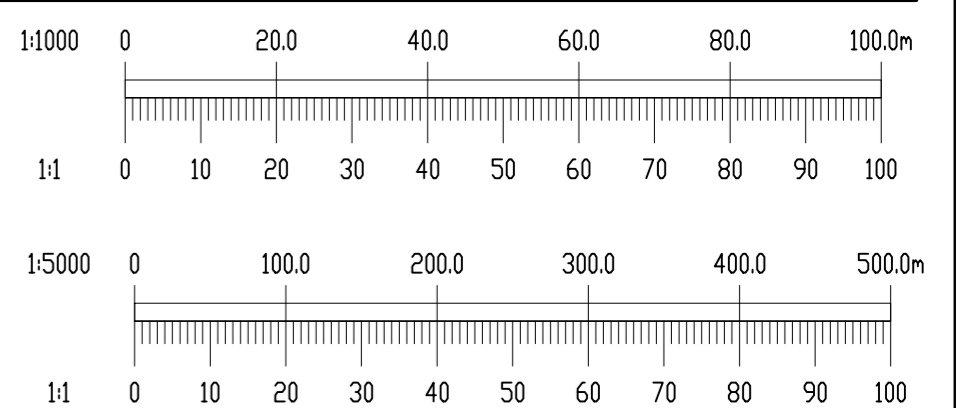

A	11/04/22	FINAL SHD SUBMISSION	PJD	MD
REV.	DATE	AMENDMENT	DRN	APPD

STATUS FOR PLANNING NOT FOR CONSTRUCTION

Waterman Moylan
Engineering Consultants
BLOCK 5, EASTPOINT BUSINESS PARK, ALFIE BYRNE ROAD, DUBLIN D03 H3F4 IRELAND.
Tel: (01) 664 8900 Fax: (01) 661 3618
Email: info@waterman-moylan.ie www.waterman-moylan.ie

CLIENT **BIRCHWELL DEVELOPMENTS LTD**
ARCHITECT **MCCROSSAN O'ROURKE MANNING ARCHITECTS**
PROJECT **BROOMFIELD SHD**
TITLE **ROAD SURFACING LAYOUT**

DRAWN PJD	DESIGNED RW	APPROVED MD	DATE NOV '20
SCALE 1:1000 @ A1	JOB NO. 18-091	DRG. NO. P002	REVISION